

# PMMT491A

## NPN Transistor

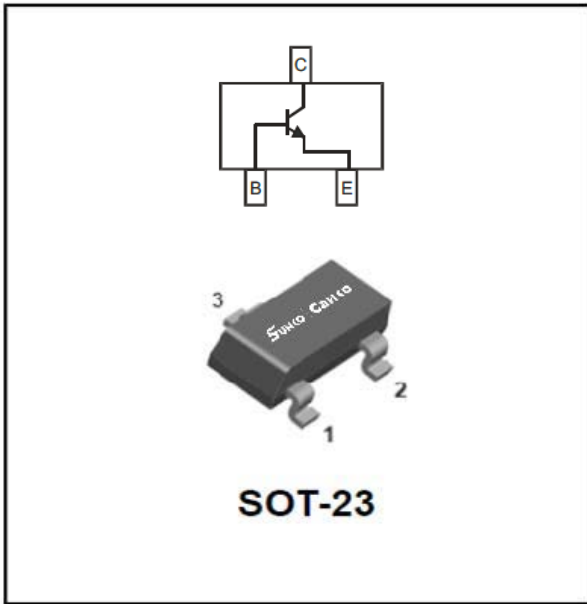

### Features

- Epoxy meets UL-94 V-0 flammability rating
- Halogen free available upon request by adding suffix "HF"
- Moisture Sensitivity Level 1
- High Conductance
- Surface mount package ideally Suited for Automatic Insertion

### Mechanical Data

- **Package:** SOT-23
- Molding compound meets UL 94 V-0 flammability rating, -compliant, halogen-free
- **Terminals:** Tin plated leads, solderable per J-STD-002 and JESD22-B102
- **Marking:** 9A

### ■ Maximum Ratings (Ta=25°C unless otherwise noted)

| Item                        | Symbol    | Unit | Value       |
|-----------------------------|-----------|------|-------------|
| Collector-Base Voltage      | $V_{CBO}$ | V    | 40          |
| Collector-Emitter Voltage   | $V_{CEO}$ | V    | 40          |
| Emitter-Base Voltage        | $V_{EBO}$ | V    | 5           |
| Collector Current           | $I_c$     | A    | 1           |
| Collector Power Dissipation | $P_c$     | mW   | 300         |
| Junction Temperature        | $T_j$     | °C   | 150         |
| Storage Temperature         | $T_{stg}$ | °C   | -55 to +150 |

### ■ Ordering Information (Example)

| PREFERRED P/N | PACKING CODE | UNIT WEIGHT(g)    | MINIMUM PACKAGE(pcs) | INNER BOX QUANTITY(pcs) | OUTER CARTON QUANTITY(pcs) | DELIVERY MODE |
|---------------|--------------|-------------------|----------------------|-------------------------|----------------------------|---------------|
| PMMT491A      | F2           | Approximate 0.008 | 3000                 | 30000                   | 120000                     | 7" reel       |

# PMMT491A

## ■ Electrical Characteristics (Ta=25°C unless otherwise noted)

| Item                                 | Symbol        | Unit | Conditions                       | Min | Typ | Max |
|--------------------------------------|---------------|------|----------------------------------|-----|-----|-----|
| Collector-base breakdown voltage     | $V_{CBO}$     | V    | $I_C=10\mu A, I_E=0$             | 40  |     |     |
| Collector-emitter breakdown voltage  | $V_{CEO^*}$   | V    | $I_C=1mA, I_B=0$                 | 40  |     |     |
| Emitter-base breakdown voltage       | $V_{EBO}$     | V    | $I_E=10\mu A, I_C=0$             | 5   |     |     |
| Collector-emitter cut-off current    | $I_{CEO}$     | nA   | $V_{CE}=30V, I_B=0$              |     |     | 100 |
| Collector-base cut-off current       | $I_{CBO}$     | nA   | $V_{CB}=30V, I_E=0$              |     |     | 100 |
| Emitter-base cut-off current         | $I_{EBO}$     | nA   | $V_{EB}=5V, I_C=0$               |     |     | 100 |
| DC current gain                      | $h_{FE}$      |      | $V_{CE}=5V, I_C=1mA$             | 300 |     |     |
|                                      | $h_{FE}$      |      | $V_{CE}=5V, I_C=500mA$           | 300 |     | 900 |
|                                      | $h_{FE}$      |      | $V_{CE}=5V, I_C=1A$              | 200 |     |     |
| Collector-emitter saturation voltage | $V_{CE(sat)}$ | V    | $I_C=100mA, I_B=1mA$             |     |     | 0.2 |
|                                      | $V_{CE(sat)}$ | V    | $I_C=500mA, I_B=50mA$            |     |     | 0.3 |
|                                      | $V_{CE(sat)}$ | V    | $I_C=1A, I_B=100mA$              |     |     | 0.5 |
| Base-emitter saturation voltage      | $V_{BE(sat)}$ | V    | $I_C=1A, I_B=100mA$              |     |     | 1.2 |
| Base-emitter voltage                 | $V_{BE}$      | V    | $V_{CE}=5V, I_C=1A$              |     |     | 1.1 |
| Collector-base output capacitance    | $C_{ob}$      | pF   | $V_{CB}=10V, f=1MHz$             |     |     | 10  |
| Transition frequency                 | $f_T$         | MHz  | $V_{CE}=10V, I_C=50mA, f=100MHz$ | 150 |     |     |

## ■ Characteristics (Typical)

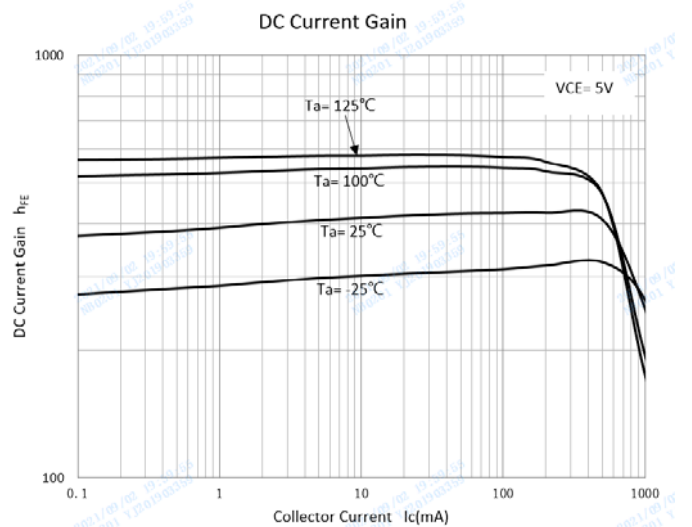
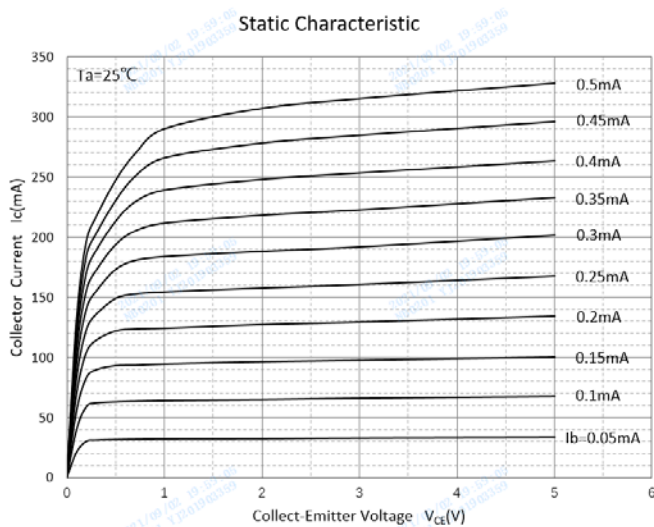

# PMMT491A

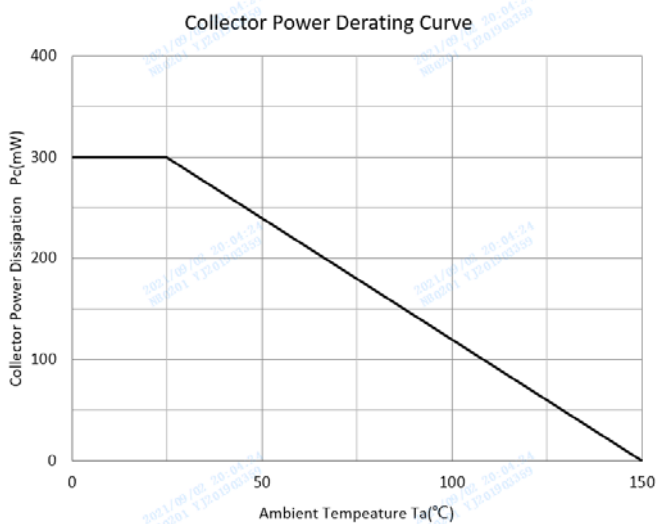
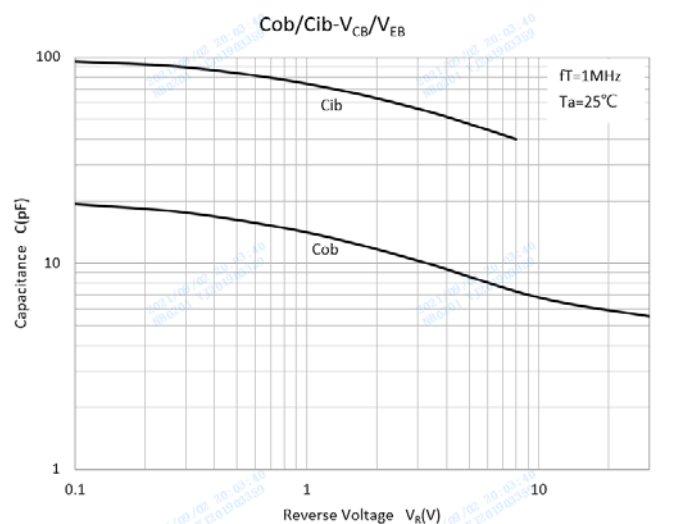
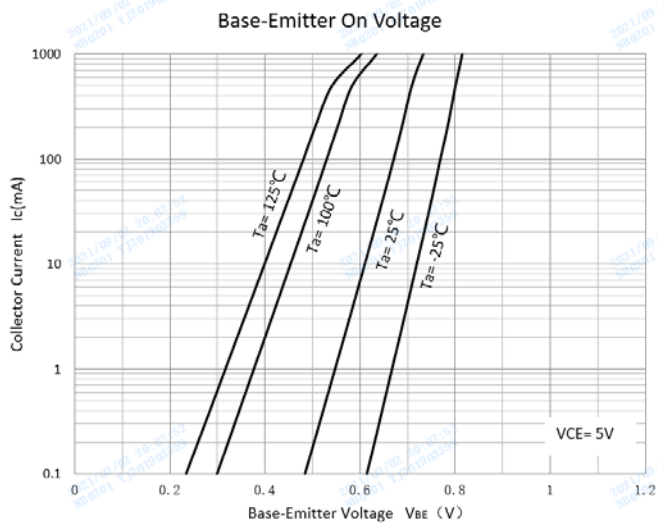
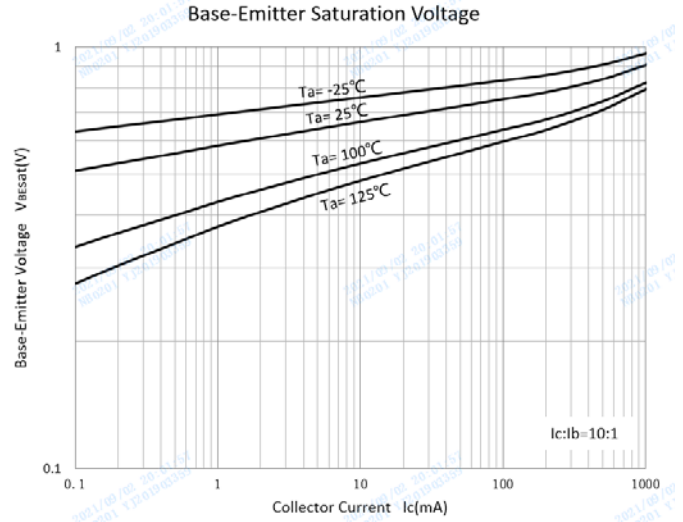
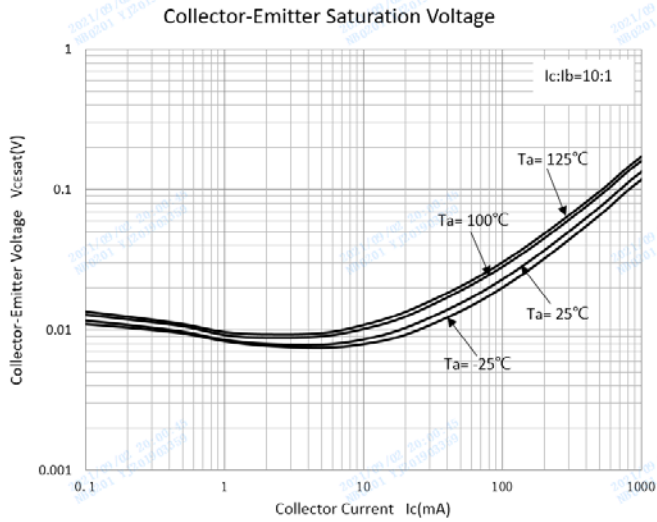

# PMMT491A

## ■SOT-23 Package Outline Dimensions

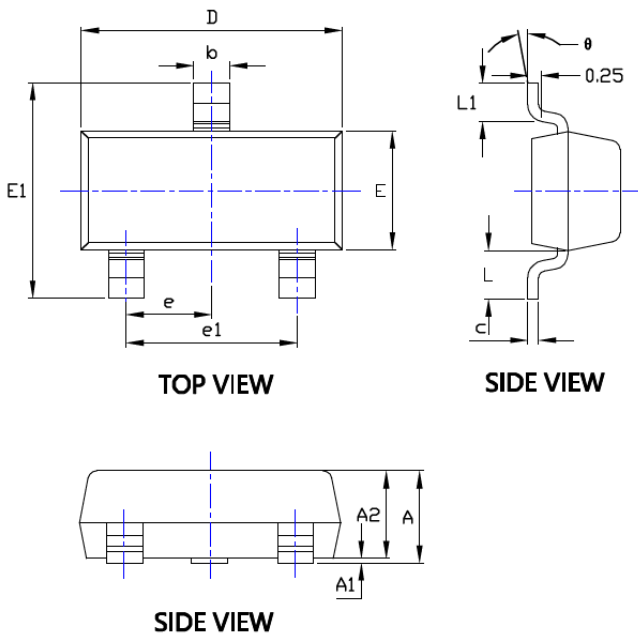

| SYMBOL   | DIMENSIONS |       |            |       |
|----------|------------|-------|------------|-------|
|          | INCHES     |       | Millimeter |       |
|          | MIN.       | MAX.  | MIN.       | MAX.  |
| A        | 0.035      | 0.045 | 0.900      | 1.150 |
| A1       | 0.000      | 0.004 | 0.000      | 0.100 |
| A2       | 0.035      | 0.041 | 0.900      | 1.050 |
| b        | 0.012      | 0.020 | 0.300      | 0.500 |
| c        | 0.004      | 0.008 | 0.100      | 0.200 |
| D        | 0.110      | 0.118 | 2.800      | 3.000 |
| E        | 0.047      | 0.055 | 1.200      | 1.400 |
| E1       | 0.089      | 0.100 | 2.250      | 2.550 |
| e        | 0.037TYP   |       | 0.950TYP   |       |
| e1       | 0.071      | 0.079 | 1.800      | 2.000 |
| L        | 0.022REF   |       | 0.550REF   |       |
| L1       | 0.012      | 0.020 | 0.300      | 0.500 |
| $\theta$ | 0°         | 8°    | 0°         | 8°    |

## ■SOT-23 Soldering Footprint

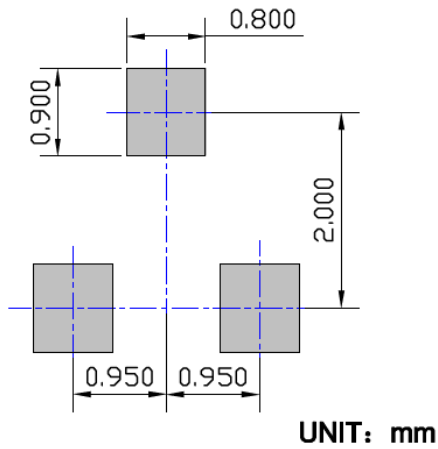

**Disclaimer**

The information presented in this document is for reference only. Shanghai Sunco Electronics Co., Ltd reserves the right to make changes without notice for the specification of the products displayed herein to improve reliability, function or design or otherwise.

The product listed herein is designed to be used with ordinary electronic equipment or devices, and not designed to be used with equipment or devices which require high level of reliability and the malfunction of which would directly endanger human life (such as medical instruments, transportation equipment, aerospace machinery, nuclear-reactor controllers, fuel controllers and other safety devices), Russiansunco or anyone on its behalf, assumes no responsibility or liability for any damages resulting from such improper use of sale.

This publication supersedes & replaces all information previously supplied. For additional information, please visit our website [http:// www.russiansunco.com](http://www.russiansunco.com) , or consult your nearest Russiansunco's sales office for further assistance.